

Access in Astralia – an Overview November 2003

Ar. Eric Martin

Arcasia Forum 12: UIA Region IV Work Programme on "Architecture for All"

 **ACCESS IN AUSTRALIA: AN OVERVIEW**

Access in Australia: An Overview

*an address by
Eric Martin*

of
EMA
Eric Martin and Associates
Architects and Access Consultants
10/68 Jardine street
KINGSTON ACT 2604
AUSTRALIA

 Eric Martin & Associates
Architects and Access Consultants

December
2003

Slide No

Arcasia Forum 12: UIA Region IV Work Programme on "Architecture for All"

 **ACCESS IN AUSTRALIA: AN OVERVIEW**

Contents

- Current Situation in Australia
- Access to Canberra's Public Open Space
- Access to Existing Buildings

 Eric Martin & Associates
Architects and Access Consultants

December
2003

Slide No



DISABILITY DISCRIMINATION ACT (DDA) 1992

This makes it "unlawful to discriminate against a person on the basis of a disability".

The Act requires people with disabilities be given equal opportunity to participate in and contribute to the full range of social, political and cultural activities.



BUILDING CODE OF AUSTRALIA (BCA)

➤ **Part D2 CONSTRUCTION OF EXITS**

- D2.10 Pedestrian Ramps

➤ **Part D3 ACCESS FOR PEOPLE WITH DISABILITIES**

- D3.2 General building access requirements
- D3.3 Parts of buildings to be accessible
- D3.4 Concessions
- D3.5 Car Parking
- D3.6 Identification of accessible facilities, services and features
- D3.7 Hearing augmentation
- D3.8 Tactile Indicators

➤ **Part E3 LIFT INSTALLATIONS**

- E3.6 Facilities for people with disabilities

➤ **Part F2 SANITARY AND OTHER FACILITIES**

- F2.4 Toilets

➤ **Part F4 LIGHT AND VENTILATION**

- F4.4 Facilities for people with disabilities

➤ **Part G4 CONSTRUCTION IN ALPINE AREAS**

- G4.5 External Ramps



**AUSTRALIAN STANDARDS (AS)**

| | | |
|------------|-------------|--|
| AS3661.1 | 1993 | Slip resistance of pedestrian surfaces – Requirements |
| AS4586 | 1999 | Slip resistance classification of new pedestrian surface materials |
| AS1428.1 | 2001 | Design for Access and Mobility. Part 1: General requirements for access – New building work |
| AS1428.2 | 1992 | Design for Access and Mobility. Part 2 Enhanced and additional requirements – Buildings and facilities |
| AS1428.4 | 2002 | Design for Access and Mobility. Part 4: Tactile ground surface indicators. |
| AS2890.1 | 1993 | Parking Facilities. Part 1: Off street car parking |
| AS2535 | 1999 | Pedestrian Push Button Assemblies |
| AS1680 | 1999 – 2001 | Interior Lighting |
| AS1158.3.1 | 1999 | Road Lighting Part 3.1 Pedestrian Area (Category P) Lighting – Performance & Installation design requirements. |
| AS1158.4 | 1987 | SAA Public Lighting Code. Part 4 Supplementary Lighting at pedestrian crossings. |

Eric Martin & Associates
Architects and Access ConsultantsDecember
2003

Slide No

**NEW STANDARDS****AS1428 Standard****Proposed Implementation Date**

| | | |
|----------|---|--|
| Part 1 | General Requirements for Access – New Building Work | July 2001 To be substituted with the Access to Premises Standard in 2004 after public consultation from late 2003/2004 |
| Part 2 | Furniture and Fitments | Public review late 2004 |
| Part 3 | Requirements for Children and Adolescents | Public review uncertain |
| Part 4 | Tactile Indicators | Revised in November 2002 (although contains some errors) |
| Part 4.2 | Signage and Way Finding Aids | Being prepared date uncertain |
| Part 5 | Communication for People who are deaf or Hearing Impaired | Being prepared. Public review late 2003 |
| Part 6 | Purpose Built Buildings | Commencing 2005 |
| Part 7 | Outdoor access | Public review 2005 |
| Part 8 | AS 4299 – 1995 Adaptable Housing | Being amended. Public review 2004 |
| Part 9 | Aged Care facilities | Public review late 2004 |
| Part 10 | Handbook on best practice in providing access. | Completion late 2004 |

Eric Martin & Associates
Architects and Access ConsultantsDecember
2003

Slide No



Current Situation

CURRENT MOVES

➤ DDA Standard "Access to Premises Standard"

- Draft Nov 2003
- Consultation early 2004
- Implementation Jan 2005

➤ BCA

- Ongoing changes

➤ A Protocol for Access to Buildings

- To be released with Access to Premises Standard

➤ Public Transport Standard (published)

➤ Education Standard (being developed)



Eric Martin & Associates
Architects and Access Consultants

December
2003

Slide No



Access to Canberra Public Open Spaces

PUBLIC SPACES

➤ Large

➤ Numerous obstacles

➤ Numerous access problems

➤ Many situations part of historical development



Eric Martin & Associates
Architects and Access Consultants

December
2003

Slide No



Access to Canberra Public Open Spaces

CANBERRA

- Walter Burley Griffin 1912
- Garden City of 320,000 people



Photo by Stephen Parish

Eric Martin & Associates
Architects and Access Consultants

December
2003

Slide No



Access to Canberra Public Open Spaces

CIVIC ACCESSIBILITY STUDY / PARLIAMENTARY ZONE

- Area
- Meeting obligations
under DDA
- Audit
- Guidelines for future
projects
- Action Plan

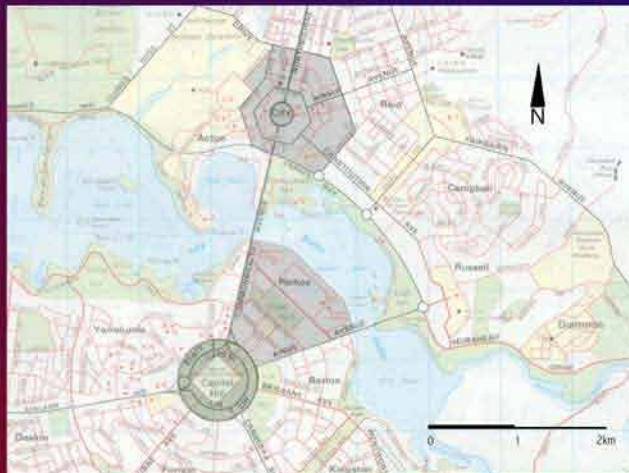

Map from Yellow Pages

Eric Martin & Associates
Architects and Access Consultants

December
2003

Slide No



Access to Canberra Public Open Spaces



Photo by Stephen Parrott

CANBERRA CIVIC CENTRE



Eric Martin & Associates
Architects and Access Consultants

December
2003

Slide No



Access to Canberra Public Open Spaces

PARLIAMENTARY ZONE



Photo by Stephen Parrott



Eric Martin & Associates
Architects and Access Consultants

December
2003

Slide No



Access to Canberra Public Open Spaces

CURRENT SITUATION

- Historical situation
- Large spaces difficult
- Inaccuracies in design/construction
- Lack of understanding of access requirements
- Failure to monitor, control, manage
- Lifestyle changes
- Lack of clear guidelines
- Confusion on who is responsible
- Lack of strength in legislation
- Complaints based DDA



Eric Martin & Associates
Architects and Access Consultants

December
2003

Slide No



Access to Canberra Public Open Spaces

OUTCOMES

- Access Policy – Canberra:
An accessible city
- Access strategy:
 - All of government Action Plan
 - Accessible transport
 - Mobility maps
 - Actions plans for general access
 - Access routes



Mobility Map



Access Routes



Eric Martin & Associates
Architects and Access Consultants

December
2003

Slide No



Access to Canberra Public Open Spaces

ACCESS GUIDELINES

Aim:

- For designers
- For authorities
- Consistency



Eric Martin & Associates
Architects and Access Consultants

December
2003

Slide No



Access to Canberra Public Open Spaces

SAMPLE OF GUIDELINES (1)

➤Tactile Ground Surface Indicators (TGSi)

- Objective
- Comment

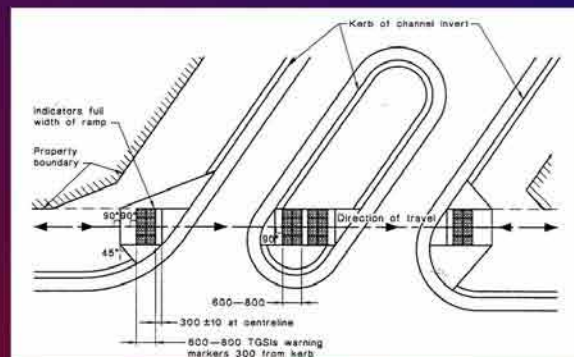

Drawing courtesy of Victorian Traffic Bureau



Eric Martin & Associates
Architects and Access Consultants

December
2003

Slide No



Access to Canberra Public Open Spaces

SAMPLE OF GUIDELINES (2)

➤ Tactile Ground Surface Indicators (TGSi)

- Description
- Location

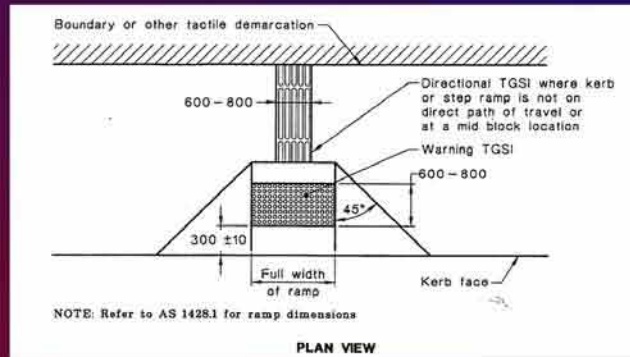

Drawing courtesy of Victorian Traffic Branch

Eric Martin & Associates

Architects and Access Consultants

December
2003

Slide No



Access to Canberra Public Open Spaces

SAMPLE OF GUIDELINES (3)

➤ Tactile Ground Surface Indicators (TGSi)

- Design Requirements
- Maintenance



Use of TGSi in Pedestrian Area where path meets Traffic Way on Grade



Use of TGSi & Barrier when Height under Stair is Less than 2,000 mm

Eric Martin & Associates

Architects and Access Consultants

December
2003

Slide No



Access Guidelines

by Eric Martin,
Chris Marcar,
Murray Mountain
and Susan Conroy

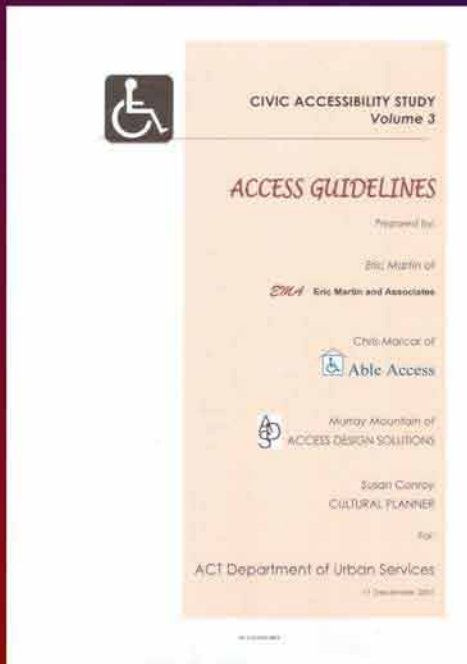

Available free of charge for
downloading from the Internet

To download these
guidelines go to
www.basis.gov.au

Then press the "links"
button, then the "Civic
Accessibility Study" button



Access Guidelines

ACT PLANNING GUIDELINES FOR ACCESS & MOBILITY

These have been established to assist the Planning Authority
to consider access issues in Development Guidelines.

Details are available from their website:

www.actpla.act.gov.au

Press link for "Planning and Development", then "Planning
Guidelines Register". The guidelines are under the heading
Interim Planning Guidelines.



Existing Building: Old Parliament House



Case Study: Old Parliament House, ACT



Eric Martin & Associates
Architects and Access Consultants

December
2003

Slide No



Existing Building: Old Parliament House

THE PROCESS

1. Review the significance of the place and identify the elements of greatest significance.
2. Undertake an Access Audit to determine existing and required levels of accessibility.
3. Evaluate access options within a conservation context. This process includes consultation with authorities and approval of the proposed action.
4. Prepare the access policy or action plan.
5. Implement the necessary action.



Eric Martin & Associates
Architects and Access Consultants

December
2003

Slide No



Existing Building: Old Parliament House

SIGNIFICANCE



National significance as the place of Federal Politics from 1927 – 1988. Rich in political history. A fine stripped classical building by John Smith Murdoch but extended and altered over its life. Many significant spaces internally



Eric Martin & Associates
Architects and Access Consultants

December
2003

Slide No



Existing Building: Old Parliament House

REPORTS



- Conservation Management Plan
- South East Wing
- North Wing
- Senate and House of Representatives Chambers and Kings Hall
- South Wing



Eric Martin & Associates
Architects and Access Consultants

December
2003

Slide No



Existing Building: Old Parliament House

AUDIT

- Need for experienced access consultant
- Association of Consultants in Access – Australia (ACAA)
- Accredited Access Consultants



Existing Building: Old Parliament House

AN AUDIT PROCESS

- Audit Checklist

Example:

| | | | | |
|----|--------|-----|---------------------------------|--|
| St | STAIRS | St1 | Open rises/no lips | Should be closed & smooth transition from riser to tread. |
| | | St2 | Lack of contrasting nosing | 50mm – 75mm wide contrasting colour |
| | | St3 | Handrails inadequate | Height to be 865 – 1000mm and extend beyond stair 300mm and turned down profile or back to the wall, 30 – 50mm diameter, both sides, continuous. |
| | | St4 | Step rises too great | Should not exceed 190mm. |
| | | St5 | No TGS | Install top & bottom of stair if handrail continuous. |
| | | St6 | Step riser and going not to BCA | Riser 115 – 190mm, Going 250 – 355mm and Quantity 2R + G 550 – 700mm. |





Existing Building:
Old Parliament House

AN AUDIT PROCESS

➤ Audit Report

Example:

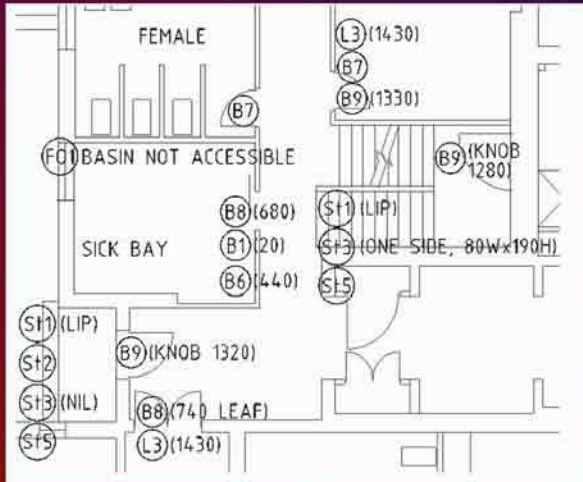

Eric Martin & Associates
Architects and Access Consultants

December 2003

Slide No



Existing Building:
Old Parliament House

THE BUILDING

➤Public Staff, Service Areas

➤ Hours of Operation

➤ Functional Usage

Example:

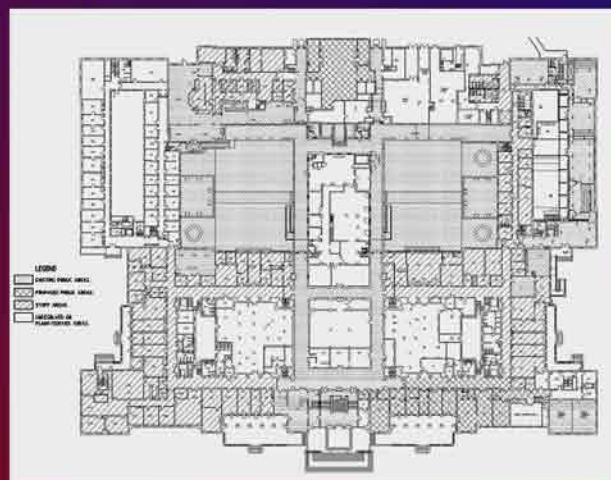

Eric Martin & Associates
Architects and Access Consultants

December 2003

Slide No



Existing Building: Old Parliament House

ACCESS ISSUES TO RESOLVE

- Parking
- Access to building entry
- Access through principal public entrance
- Circulation through main building
- Access to other floors
- Egress
- Toilets
- Other facilities
- Information



Eric Martin & Associates
Architects and Access Consultants

December
2003

Slide No



Existing Building: Old Parliament House

ACCESS REQUIREMENTS

- BCA Compliance – A Minimum Level
- Improved Access Requirements
 - Parts of AS 1428.2
 - A move toward a DDA Standard
- Further Enhancement Provisions
 - HREOC Advisory Notes on Access to Premises
 - Full Compliance with AS 1428.2 for all parts of the building



Eric Martin & Associates
Architects and Access Consultants

December
2003

Slide No



Existing Building: Old Parliament House

RISK MANAGEMENT

- Those that cause a safety problem for most people.
- Those that are required for easy access around the building or area.
- Less critical work and minor dimensional non conformances.



Eric Martin & Associates
Architects and Access Consultants

December
2003

Slide No



Existing Building: Old Parliament House



Eric Martin & Associates
Architects and Access Consultants

December
2003

Slide No



Existing Building: Old Parliament House



Eric Martin & Associates
Architects and Access Consultants

December
2003

Slide No



Existing Building: Old Parliament House

MANAGED OPTIONS

- Tours – guided, self guided, unguided
- Staff – accommodation, facilities
- Information
- Egress
- Lighting
- Access



Eric Martin & Associates
Architects and Access Consultants

December
2003

Slide No



Existing Building: Old Parliament House



IMPLEMENTATION

➤ Budget Costs

➤ Action Plan

- Phase 1: Access into the Building
- Phase 2: Secondary Entries, Internal Circulation
- Phase 3: Facilities

➤ Review



Eric Martin & Associates
Architects and Access Consultants

December
2003

Slide No



Improving Access to Heritage Buildings

by Eric Martin

Available free of charge for
downloading from the Internet



Go to www.emaa.com.au
for links to this booklet



Eric Martin & Associates
Architects and Access Consultants

December
2003

Slide No



UNIVERSAL ACCESSIBILITY: THE PEOPLE ORIENTED APPROACH

- Understanding the needs of individuals
- Sharing Information
- Work towards Worlds best practice



Eric Martin & Associates
Architects and Access Consultants

December
2003

Slide No

Eric Martin, FRAIA, M B Env, B Arch (Hons) Managing Director of Eric Martin and Associates

Eric Martin is an architect in private practice with more than 30 years experience. During that time he has had more than 20 years specialist experience in Heritage and Access. He is a fellow of the Royal Australian Institute of Architects.

He is a vice chairman of the RAIA National Heritage Committee and a member of the RAIA National Access Working Group. He is on the national executive of the Association of Consultants in Access Australia. He is the RAIA nominee to the UIA Regional Committee on Access.